

## BENTLEY LEAP BRIDGE STEEL

LEAP Bridge Steel is an integrated 3D steel bridge design and rating application that provides parametric modeling, streamlined analysis, design and rating of straight or curved I-girder bridges. Bridges are modeled completely in 3D with full 3D visualization, and member cross sections can be selected from supplied libraries of standard sections or defined as built-up members. LEAP Bridge Steel is powered by the STAAD.Pro engine for structural analysis and offers users two analysis options: line girder or 3D grillage. The software conforms to the provisions of the 6th Edition of the *AASHTO LRFD Bridge Design Specification* and the 2nd Edition of the *AASHTO Manual for Bridge Evaluation*. A free demo is available.

For more information, visit [www.bentley.com](http://www.bentley.com) or call 800.BENTLEY.

## QUICKFRAMES

QuickFrames are bolt-on, adjustable, pre-engineered roof opening frames that provide structural support for HVAC units, coolers, roof turbines, skylights, roof drains and other rooftop-mounted equipment. The frames adjust from 4-ft to 10-ft roof truss spans with 15-in. to 96-in. openings. As the frames are adjustable, they slide into most applications in minutes, eliminating the need for welding roof frame openings. This unique flexibility eliminates a number of time-consuming commercial tasks including design detailing of roof openings and frame rework due to variances or mislocated frames.

For more information, visit [www.quickframes.us](http://www.quickframes.us) or call 480.464.1500.

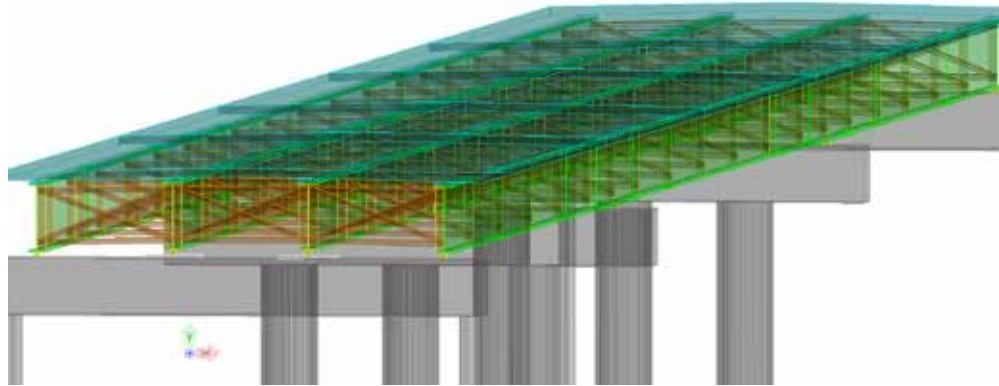

## LINDAPTER HOLLO-BOLT

Hollo-Bolt is a labor-saving connection for HSS that is quickly installed by inserting the fastener into a pre-drilled hole and tightening it with a torque wrench, saving the contractor time and money. The fastener is available off-the-shelf at standard pricing from Lindapter's network of local distributors. Product sizes range from 5/16 in. to 3/4 in. to suit a variety of applications, and a hot-dip galvanized finish offers added corrosion protection. Hollo-Bolt is available in two versions: the original three-part design for regular applications and the enhanced five-part High Clamping Force (HCF) version for higher-strength structural connections; both are ICC-ES approved and are covered by ESR-3330.

For more information, visit [www.lindapterusa.com](http://www.lindapterusa.com) or call 610.590.2160.

